



ANCHORS

section 1



1: ANCHORS



ZAMAC HAMMER DRIVE ANCHORS

Description/Application: Hammer drive anchors are medium duty anchors which can be used in concrete, block, brick and stone. They are shipped completely assembled and can be quickly hammered into place, allowing for fast on the job installation. The single head nail like expander pin provides a permanent, tamper proof installation.

PART NUMBER	SIZE	DRILL SIZE	MAX FIXTURE THICKNESS	QTY
1ZHD31678	3/16 x 7/8	3/16	1/4	100
1ZHD14034	1/4 x 3/4	1/4	1/8	100
1ZHD14100	1/4 x 1	1/4	1/4	100
1ZHD14114	1/4 x 1-1/4	1/4	1/2	100
1ZHD14112	1/4 x 1-1/2	1/4	3/4	100
1ZHD14200	1/4 x 2	1/4	1 1/4	100
1ZHD14212	1/4 x 2-1/2	1/4	1 3/4	100
1ZHD14300	1/4 x 3	1/4	2 1/4	100

Note: Also available with a stainless steel nail.



ROUND NYLON NAILIN ANCHORS

Description/Application: Hammer drive anchors are medium duty anchors which can be used in concrete, block, brick and stone. They are furnished completely assembled and can be quickly hammered into place, allowing for fast on the job installation. The single head nail like expander pin provides a permanent, tamper proof installation.

PART NUMBER	SIZE	DRILL SIZE	QTY
1RNN14100	1/4 x 1	1/4	100
1RNN14112	1/4 x 1-1/2	1/4	100
1RNN14200	1/4 x 2	1/4	100



MUSHROOM NYLON NAILIN ANCHORS

Description/Application: Hammer drive anchors are medium duty anchors which can be used in concrete, block, brick and stone. They are shipped completely assembled and can be quickly hammered into place, allowing for fast on the job installation. The single head nail like expander pin provides a permanent, tamper proof installation.

PART NUMBER	SIZE	DRILL SIZE	QTY
1MNN14100	1/4 x 1	1/4	100
1MNN14112	1/4 x 1-1/2	1/4	100
1MNN14200	1/4 x 2	1/4	100



FLAT SPLIT DRIVE ANCHORS, CARBON STEEL

Description/Application: The split drive anchor can be used in concrete, hard masonry and stone. Made of high grade steel with a memory, these anchors are easily hammered into a predrilled hole. When hammered the anchor exerts tremendous outward force on the inner wall of the hole, creating a secure fastening.

PART NUMBER	SIZE	DRILL SIZE	MINIMUM EMBEDMENTS	QTY
1FSD14112	1/4 x 1-1/2	1/4	1 1/8	100
1FSD14200	1/4 x 2	1/4	1 1/8	100
1FSD14212	1/4 x 2-1/2	1/4	1 1/8	100
1FSD14300	1/4 x 3	1/4	1 1/8	100
1FSD14312	1/4 x 3-1/2	1/4	1 1/8	100
1FSD14400	1/4 x 4	1/4	1 1/8	100



SPIKE® ANCHORS

The SPIKE® anchor is a one-piece, tamper-proof vibration resistant anchor for use in concrete block, brick or stone. Several head styles and anchor materials are available. The SPIKE® anchor is formed with an “s” shaped configuration at the working end of the anchor to create an expansion mechanism. Since the anchor is pre-expanded, there is no secondary tightening operation required which greatly reduces the overall cost of an anchor installation.

MUSHROOM HEAD CARBON STEEL SPIKE®

PART NUMBER	SIZE	DRILL DIAMETER	BOX QTY
1MH3161	3/16 x 1	3/16	100
1MH316114	3/16 x 1-1/4	3/16	100
1MH316112	3/16 x 1-1/2	3/16	100
1MH3162	3/16 x 2	3/16	100
1MH316212	3/16 x 2-1/2	3/16	100
1MH3163	3/16 x 3	3/16	100
1MH316312	3/16 x 3-1/2	3/16	100
1MH3164	3/16 x 4	3/16	100
1MH141	1/4 x 1	1/4	100
1MH14114	1/4 x 1-1/4	1/4	100
1MH14112	1/4 x 1-1/2	1/4	100
1MH142	1/4 x 2	1/4	100
1MH14212	1/4 x 2-1/2	1/4	100
1MH143	1/4 x 3	1/4	100
1MH14312	1/4 X 3-1/2	1/4	100
1MH144	1/4 x 4	1/4	100
1MH382	3/8 x 2	3/8	25
1MH38212	3/8 x 2-1/2	3/8	25
1MH383	3/8 x 3	3/8	25
1MH38312	3/8 x 3-1/2	3/8	25



MUSHROOM HEAD TYPE 316 STAINLESS STEEL SPIKE®

PART NUMBER	SIZE	DRILL DIAMETER	BOX QTY
1MH3161SS	3/16 x 1	3/16	100
1MH316114SS	3/16 x 1-1/4	3/16	100
1MH316114SSSW	3/16 x 1-1/4 (Supplied with EPDM Sealing Washer)	3/16	100
1MH316112SS	3/16 x 1-1/2	3/16	100
1MH3162SS	3/16 x 2	3/16	100
1MH316212SS	3/16 x 2-1/2	3/16	100
1MH141SS	1/4 x 1	1/4	100
1MH14114SS	1/4 x 1-1/4	1/4	100
1MH14112SS	1/4 x 1-1/2	1/4	100
1MH142SS	1/4 x 2	1/4	100
1MH14212SS	1/4 x 2-1/2	1/4	100
1MH143SS	1/4 x 3	1/4	100
1MH14312SS	1/4 x 3-1/2	1/4	100
1MH144SS	1/4 x 4	1/4	100
1MH382SS	3/8 x 2	3/8	25
1MH38212SS	3/8 x 2-1/2	3/8	25
1MH383SS	3/8 x 3	3/8	25



1: ANCHORS



FLAT HEAD CARBON STEEL SPIKE®

PART NUMBER	SIZE	DRILL DIAMETER	BOX QTY
1FH316212	3/16 x 2-1/2	3/16	100
1FH3163	3/16 x 3	3/16	100
1FH3164	3/16 x 4	3/16	100
1FH14112	1/4 x 1-1/2	1/4	100
1FH142	1/4 x 2	1/4	100
1FH14212	1/4 x 2-1/2	1/4	100
1FH143	1/4 x 3	1/4	100
1FH14312	1/4 x 3-1/2	1/4	100
1FH144	1/4 x 4	1/4	100



ROD HANGING - PIPE SPIKE®

PART NUMBER	HEAD SIZE	SHANK DIAMETER	MIN. EMBED.	BOX QTY
1RHPS14	1/4	3/16	1-1/4	100
1RHPS38	3/8	1/4	1-3/4	100



SUSPENDED CEILING - TIE WIRE SPIKE®

PART NUMBER	SIZE	DRILL DIAMETER	MIN. EMBED.	TIE WIRE HOLE SIZE	BOX QTY
1SCTW316	3/16	3/16	1-1/4	3/16	100
1SCTW14	1/4	1/4	1-1/4	9/32	100



CONCRETE FORMING - FORMING SPIKE®

PART NUMBER	SIZE	DRILL DIAMETER	MIN. EMBED.	BOX QTY
1CFFS316112	3/16 x 1-1/2	3/16	1-1/4	100
1CFFS3162	3/16 x 2	3/16	1-1/4	100
1CFFS316234	3/16 x 2-3/4	3/16	1-1/4	100
1CFFS14234	1/4 x 2-3/4	1/4	1-1/4	100



1: ANCHORS

WEDGE ANCHORS, CARBON STEEL, ZINC PLATED

Description/Application: The wedge anchor is for heavy duty fastening applications where high pull out values in concrete are needed. The anchor and the hole diameter are the same, simplifying the anchor installation by placing the anchor through the existing hole in the material to be fastened. Used in fastening sheet metal, steel, or aluminum angles, or wood to concrete. Due to its high resistance to vibratory loads, this anchor is ideal for installing machinery, hand rails, dock bumpers, storage racks, etc.

PART NUMBER	SIZE	DRILL SIZE	MAX FIXTURE THICKNESS	QTY
1WAZ14134	1/4 x 1-3/4	1/4	3/8	100
1WAZ14214	1/4 x 2-1/4	1/4	7/8	100
1WAZ14314	1/4 x 3-1/4	1/4	1 7/8	100
1WAZ38214	3/8 x 2-1/4	3/8	3/8	50
1WAZ38234	3/8 x 2-3/4	3/8	7/8	50
1WAZ38300	3/8 x 3	3/8	1 1/8	50
1WAZ38312	3/8 x 3-1/2	3/8	1 5/8	50
1WAZ38334	3/8 x 3-3/4	3/8	1 7/8	50
1WAZ38500	3/8 x 5	3/8	3 1/8	50
1WAZ38700	3/8 x 7	3/8	4 3/4	50
1WAZ12234	1/2 x 2-3/4	1/2	3/8	50
1WAZ12334	1/2 x 3-3/4	1/2	1 1/8	50
1WAZ12412	1/2 x 4-1/2	1/2	1 1/2	50
1WAZ12512	1/2 x 5-1/2	1/2	2 3/4	50
1WAZ12700	1/2 x 7	1/2	4 1/4	25
1WAZ12414	1/2 x 4-1/4	1/2	1 1/4	25
1WAZ58312	5/8 x 3-1/2	5/8	3/8	25
1WAZ58412	5/8 x 4-1/2	5/8	1 1/8	25
1WAZ58500	5/8 x 5	5/8	1 5/8	25
1WAZ58600	5/8 x 6	5/8	2 5/8	25
1WAZ58700	5/8 x 7	5/8	3 5/8	25
1WAZ58812	5/8 x 8-1/2	5/8	5 1/8	25
1WAZ58100	5/8 x 10	5/8	6 1/2	25
1WAZ34414	3/4 x 4-1/4	3/4	5/8	20
1WAZ34434	3/4 x 4-3/4	3/4	1 1/8	20
1WAZ34512	3/4 x 5-1/2	3/4	1 3/4	20
1WAZ34614	3/4 x 6-1/4	3/4	2 1/4	20
1WAZ34700	3/4 x 7	3/4	3	20
1WAZ34812	3/4 x 8-1/2	3/4	4 1/2	10
1WAZ34100	3/4 x 10	3/4	6	10
1WAZ34120	3/4 x 12	3/4	8	10
1WAZ78600	7/8 x 6	7/8	1 3/8	10
1WAZ78800	7/8 x 8	7/8	3 3/8	10
1WAZ78100	7/8 x 10	7/8	5 3/8	10
1WAZ10600	1 x 6	1	1/2	10
1WAZ10900	1 x 9	1	3 1/2	10
1WAZ10120	1 x 12	1	6 1/2	5
1WAZ11490	1-1/4 x 9	1 1/4	2 1/8	5
1WAZ11412	1-1/4 x 12	1 1/4	5 1/8	5

Note: Most sizes also available in Stainless Steel.



1: ANCHORS



HEX NUT SLEEVE ANCHORS, CARBON STEEL, ZINC PLATED

Description/Application: The sleeve anchor is the most versatile heavy duty anchor available. The sleeve expansion device allows this anchor to be used in cement, block, thin wall or solid concrete, brick or stone. Ribbed sleeve design assures holding power of expansion sleeve.

PART NUMBER	SIZE	DRILL SIZE	MAX FIXTURE THICKNESS	QTY
1ASA14058	1/4 x 5/8 *	1/4	1/8	100
1ASA14138	1/4 x 1-3/8 *	1/4	1/4	100
1ASA14214	1/4 x 2-1/4 *	1/4	1 1/8	100
1HSA56112	5/16 x 1-1/2	5/16	1/4	100
1HSA56212	5/16 x 2-1/2	5/16	1 1/4	100
1HSA38178	3/8 x 1-7/8	3/8	3/8	50
1HSA38300	3/8 x 3	3/8	1 1/2	50
1HSA38400	3/8 x 4	3/8	2 1/2	50
1HSA12214	1/2 x 2-1/4	1/2	3/4	25
1HSA12300	1/2 x 3	1/2	1 1/2	25
1HSA12400	1/2 x 4	1/2	2 1/2	25
1HSA12514	1/2 x 5-1/4	1/2	3 3/4	25
1HSA12600	1/2 x 6	1/2	4 1/2	25
1HSA58214	5/8 x 2-1/4	5/8	1/4	25
1HSA58300	5/8 x 3	5/8	1	25
1HSA58414	5/8 x 4-1/4	5/8	2 1/4	10
1HSA58600	5/8 x 6	5/8	4	10
1HSA34212	3/4 x 2-1/2	3/4	1/2	10
1HSA34414	3/4 x 4-1/4	3/4	2 1/4	5
1HSA34514	3/4 x 5-1/4	3/4	3 3/4	5
1HSA34614	3/4 x 6-1/4	3/4	4 1/4	5
1HSA34712	3/4 x 7-1/2	3/4	6	5

* These sizes come with acorn nuts instead of hex nuts.



FLAT HEAD COMBO SLEEVE ANCHORS, ZINC PLATED

Description/Application: The sleeve anchor is the most versatile heavy duty anchor available. The sleeve expansion device allows this anchor to be used in cement, block, thin wall or solid concrete, brick or stone. Ribbed sleeve design assures holding power of expansion sleeve.

PART NUMBER	SIZE	DRILL SIZE	MAX FIXTURE THICKNESS	QTY
1FSA14118	1/4 x 1-1/8	1/4	1/8	100
1FSA14200	1/4 x 2	1/4	7/8	100
1FSA14200T	1/4 x 2 Threshold	1/4	7/8	100
1FSA14300	1/4 x 3	1/4	1 7/8	100
1FSA14400	1/4 x 4	1/4	2 7/8	100
1FSA14514	1/4 x 5-1/4	1/4	4 1/8	100
1FSA38300	3/8 x 3	3/8	1 3/8	50
1FSA38400	3/8 x 4	3/8	2 3/8	50
1FSA38500	3/8 x 5	3/8	3 3/8	50
1FSA38600	3/8 x 6	3/8	4 3/8	50

1FSA14200T is used for threshold floor plates.



DOUBLE EXPANSION SHIELDS

Description/Application: The double expansion shield is used for medium duty applications in rock, concrete and brick. This anchor eliminates high stress points detrimental in fastening into materials of medium hardness. This anchor expands fully, has high gripping power, and is ideal where there are shear loads or where the bolt is subject to side pressure or vibration.

PART NUMBER	SIZE	DRILL SIZE	LENGTH	QTY
1DES14	1/4	1/2	1 3/8	100
1DES56	5/16	5/8	1 5/8	50
1DES38	3/8	3/4	2	50
1DES12	1/2	7/8	2 1/2	25
1DES58	5/8	1	2 3/4	25
1DES34	3/4	1 1/4	4	10



1: ANCHORS

DROPIN ANCHORS, CARBON STEEL, ZINC PLATED

Description/Application: The drop-in anchor is used in medium to heavy duty applications in solid mediums such as concrete and stone. A flush internal threaded anchor, the drop-in houses an internal plug which is held securely in place even when used in overhead applications. Drop-ins are frequently used for overhead applications, including hanging pipe, duct work, machinery, etc. Drop-ins are made of carbon steel and zinc plated.

PART NUMBER	SIZE	DRILL SIZE	QTY
1DAZ14	1/4	3/8	100
1DAZ38	3/8	1/2	50
1DAZ12	1/2	5/8	50
1DAZ58	5/8	7/8	25
1DAZ34	3/4	1	25



DROPIN ANCHOR SETTING TOOLS

PART NUMBER	SIZE
1DAT14	1/4
1DAT38	3/8
1DAT12	1/2
1DAT58	5/8
1DAT34	3/4

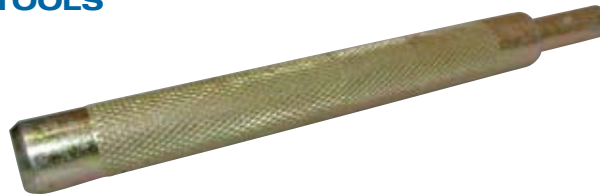

The SKYDRIVE anchor is a one-piece, steel threaded fastening system for suspending steel threaded rod vertically overhead in pipe hanging, fire protection, electrical conduit and cable-tray applications. SKYDRIVE anchors can replace beam clamps, powder-actuated stud pins or ceiling flanges, and eliminate labor-intensive operations such as pre-punching or drilling of steel components.

PART NUMBER	SCREW SIZE	ROD SIZE	MOUNT	QTY
1SWV14	5/16 x 2-1/4	1/4	Vertical	50
1SWV38	5/16 x 2-1/4	3/8	Vertical	50
1SWV383	5/16 x 3	3/8	Vertical	50
1SWV12	5/16 x 2-1/4 w/ adaptor	1/2	Vertical	50
1SWS38	5/16 x 2-1/4	3/8	Side	50



PART NUMBER	SCREW SIZE	ROD SIZE	MOUNT	QTY
1SSV14	1/4-20 x 1	1/4	Vertical	50
1SSV38	1/4-20 x 2	3/8	Vertical	50

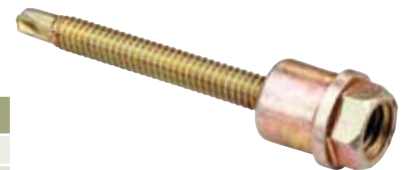

PART NUMBER	SCREW SIZE	ROD SIZE	MOUNT	QTY
1SCV14	5/16 x 2-1/4	1/4	Vertical	50
1SCV38	5/16 x 2-1/4	3/8	Vertical	50
1SCV12	5/16 x 2-1/4 w/ adaptor	1/2	Vertical	50
1SCS38	5/16 x 2-1/4	3/8	Side	50

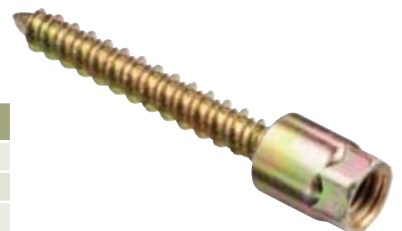

1: ANCHORS



ALL-PURPOSE SKYDRIVE[®] FOR WOOD, STEEL, AND CONCRETE

Special SKYDRIVE anchor design for use in steel, wood or concrete helps reduce your inventory; no need to carry separate parts for these different materials.

PART NUMBER	SCREW SIZE	ROD SIZE	MOUNT	QTY
1SAV14	1/4-10 x 2	1/4	Vertical	50
1SAV38	1/4-10 x 2	3/8	Vertical	50
1SAS38	1/4-10 x 2	3/8	Side	50

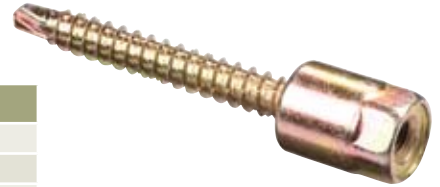

SKYDRIVE[®] DRIVERS & ACCESSORIES

PART NUMBER	DESCRIPTION	QTY
1SA	Adapter for Converting 3/8 to 1/2	1
1SD	Standard Drive Socket	1
1SDSC	Drive Sleeve for Concrete	1
1SBA	Bit Adaptor and Hex Key Kit	1

SAMMY SCREWS FOR WOOD

PART NUMBER	SCREW SIZE	ROD SIZE	MOUNT	QTY
1GST200	1/4 x 2	1/4	Vertical	25
1GST10	1/4 x 1	3/8	Vertical	25
1GST20	1/4 x 2	3/8	Vertical	25
1GST30	1/4 x 3	3/8	Vertical	25
1GST25	3/8 x 2-1/2	3/8	Vertical	25
1GST2	1/4 x 2	1/2	Vertical	25
1SWG20	1/4 x 2	3/8	Side	25

Note: Other Sizes Available.



SAMMY SCREWS FOR CONCRETE

PART NUMBER	SCREW SIZE	ROD SIZE	MOUNT	QTY
1CST200	5/16 x 1-3/4	1/4	Vertical	25
1CST20	5/16 x 1-3/4	3/8	Vertical	25
1CST2	5/16 x 1-3/4	1/2	Vertical	25
1SWC20	5/16 x 1-3/4	3/8	Side	25

Note: Other Sizes Available.

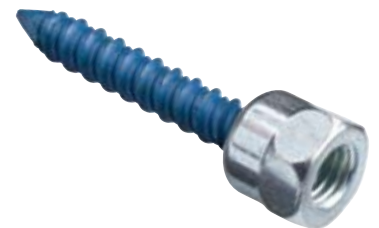

SAMMY SCREWS FOR STEEL

PART NUMBER	SCREW SIZE	ROD SIZE	MOUNT	QTY
1DST200	1/4-14 x 2	1/4	Vertical	25
1DST20	1/4-14 x 2	3/8	Vertical	25
1DST2	1/4-14 x 2	1/2	Vertical	25
1SWD20	1/4-14 x 2	3/8	Side	25

Note: Other Sizes Available.



1: ANCHORS

SAMMY SCREW DRIVERS

PART NUMBER	COLOR	Use With	QTY
18113910	Black	Sammys for 1/4 and 3/8 Rod	1
18114910	Red	Sammys for 1/2 Rod and Side Mount	1

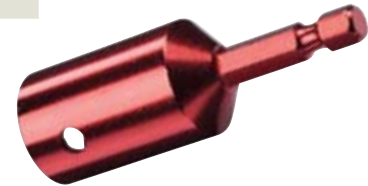

HEX CONCRETE SCREWS, BLUE COATED

Description/Application: The concrete screw is for medium duty fastening applications. It can be used in c.i.p., concrete, hollow core block, solid block, brick, or any other masonry material. This anchor cuts threads into concrete and it can later be removed for adjustment, shimming or leveling and then it can be re-driven into the same hole.

PART NUMBER	SIZE	DRILL SIZE	MAX FIXTURE THICKNESS	QTY
1CSH36114	3/16 x 1-1/4	5/32 x 3 1/2	1/4	100
1CSH36134	3/16 x 1-3/4	5/32 x 3 1/2	3/4	100
1CSH36214	3/16 x 2-1/4	5/32 x 4 1/2	1 1/4	100
1CSH36234	3/16 x 2-3/4	5/32 x 4 1/2	1 3/4	100
1CSH36314	3/16 x 3-1/4	5/32 x 4 1/2	2 1/4	100
1CSH36334	3/16 x 3-3/4	5/32 x 5 1/2	2 3/4	100
1CSH36400	3/16 x 4	5/32 x 5 1/2	3	100
1CSH14114	1/4 x 1-1/4	3/16 x 3 1/2	1/4	100
1CSH14134	1/4 x 1-3/4	3/16 x 3 1/2	3/4	100
1CSH14214	1/4 x 2-1/4	3/16 x 4 1/2	1 1/4	100
1CSH14234	1/4 x 2-3/4	3/16 x 4 1/2	1 3/4	100
1CSH14314	1/4 x 3-1/4	3/16 x 4 1/2	2 1/4	100
1CSH14334	1/4 x 3-3/4	3/16 x 5 1/2	2 3/4	100
1CSH14400	1/4 x 4	3/16 x 5 1/2	3	100



PHILLIPS FLAT CONCRETE SCREWS, BLUE COATED

Description/Application: The concrete screw is for medium duty fastening applications. It can be used in c.i.p., concrete, hollow core block, solid block, brick, or any other masonry material. This anchor cuts threads into concrete and it can later be removed for adjustment, shimming or leveling and then it can be re-driven into the same hole.

PART NUMBER	SIZE	DRILL SIZE	MAX FIXTURE THICKNESS	QTY
1CSF36114	3/16 x 1-1/4	5/32 x 3 1/2	1/4	100
1CSF36134	3/16 x 1-3/4	5/32 x 3 1/2	3/4	100
1CSF36214	3/16 x 2-1/4	5/32 x 4 1/2	1 1/4	100
1CSF36234	3/16 x 2-3/4	5/32 x 4 1/2	1 3/4	100
1CSF36314	3/16 x 3-1/4	5/32 x 4 1/2	2 1/4	100
1CSF36334	3/16 x 3-3/4	5/32 x 5 1/2	2 3/4	100
1CSF36400	3/16 x 4	5/32 x 5 1/2	3	100
1CSF14114	1/4 x 1-1/4	3/16 x 3 1/2	1/4	100
1CSF14134	1/4 x 1-3/4	3/16 x 3 1/2	3/4	100
1CSF14214	1/4 x 2-1/4	3/16 x 4 1/2	1 1/4	100
1CSF14234	1/4 x 2-3/4	3/16 x 4 1/2	1 3/4	100
1CSF14314	1/4 x 3-1/4	3/16 x 4 1/2	2 1/4	100
1CSF14334	1/4 x 3-3/4	3/16 x 5 1/2	2 3/4	100
1CSF14400	1/4 x 4	3/16 x 5 1/2	3	100



1: ANCHORS



ROUND COMBO TOGGLE BOLTS, ZINC PLATED

PART NUMBER	SIZE	DRILL SIZE	QTY
1RTB0182	1/8 x 2	3/8	50
1RTB0183	1/8 x 3	3/8	50
1RTB0184	1/8 x 4	3/8	50
1RTB3162	3/16 x 2	1/2	50
1RTB3163	3/16 x 3	1/2	50
1RTB3164	3/16 x 4	1/2	50
1RTB3165	3/16 x 5	1/2	50
1RTB3166	3/16 x 6	1/2	50
1RTB0142	1/4 x 2	5/8	50
1RTB0143	1/4 x 3	5/8	50
1RTB0144	1/4 x 4	5/8	50
1RTB0145	1/4 x 5	5/8	50
1RTB0146	1/4 x 6	5/8	50
1RTB5163	5/16 x 3	7/8	50
1RTB5164	5/16 x 4	7/8	50
1RTB5165	5/16 x 5	7/8	50
1RTB5166	5/16 x 6	7/8	50
1RTB0383	3/8 x 3	1	25
1RTB0384	3/8 x 4	1	25
1RTB0385	3/8 x 5	1	25
1RTB0386	3/8 x 6	1	25
1RTB0124	1/2 x 4	1 1/4	10
1RTB0126	1/2 x 6	1 1/4	10



TOGGLE WINGS, ZINC PLATED

PART NUMBER	SIZE	QTY
1TWZ018	1/8	100
1TWZ316	3/16	100
1TWZ014	1/4	100
1TWZ516	5/16	50
1TWZ038	3/8	50
1TWZ012	1/2	25



SNAPTOGGLE™

The SNAPTOGGLE™ is an innovative pre-assembled anchor which consists of a steel wing and an engineered plastic leg. When compared to traditional toggle bolts, this anchor uses a smaller hole and is significantly stronger.

PART NUMBER	SIZE	DRILL SIZE	QTY
1ST018	1/8	3/8	100
1ST316	3/16	1/2	100
1ST014	1/4	5/8	50



CONICAL PLASTIC ANCHORS

PART NUMBER	SIZE	DRILL SIZE	QTY
1CPA0608	6 - 8	3/16	100
1CPA0810	8 - 10	3/16	100
1CPA1012	10 - 12	1/4	100
1CPA1416	14 - 16	5/16	100



1: ANCHORS

CONICAL PLASTIC ANCHOR KITS

PART NUMBER	SIZE	DRILL SIZE	SCREW SIZE	BOX QTY
1CAK0608	6 - 8	3/16	6 x 1	100
1CAK0810	8 - 10	3/16	8 x 1	100
1CAK1012	10 - 12	1/4	10 x 1 1/4	100
1CAK1416	14 - 16	5/16	14 x 1-1/4	50



RIBBED PLASTIC ANCHORS

PART NUMBER	SIZE	DRILL SIZE	QTY
1RPA0608	6 - 8	3/16	100
1RPA1012	10 - 12	1/4	100
1RPA1416	14 - 16	5/16	100



WOOD SCREW ANCHORS, LEAD

Quick installation of lighter weight fixtures in masonry. Made of lead, it will expand without turning in soft material. Withstands extreme changes in temperatures and is not affected by moisture or chemicals.

PART NUMBER	SIZE	DRILL SIZE	QTY
1WSA0608034	6 - 8 x 3/4	1/4	100
1WSA0608100	6 - 8 x 1	1/4	100
1WSA0608112	6 - 8 x 1-1/2	1/4	100
1WSA1014034	10 - 14 x 3/4	5/16	100
1WSA1014100	10 - 14 x 1	5/16	100
1WSA1014112	10 - 14 x 1-1/2	5/16	100
1WSA1618100	16 - 18 x 1	3/8	100
1WSA1618112	16 - 18 x 1-1/2	3/8	100



VINYL PLASTIC PLUGS

PART NUMBER	COLOR	LENGTH	QTY
1VPW100	Yellow	1	100
1VPN100	Green	1	100
1VPN114	Green	1-1/4	100
1VPN112	Green	1-1/2	100
1VPN200	Green	2	100
1VPE112	Blue	1-1/2	100
1VPE200	Blue	2	100
1VPY112	Gray	1-1/2	100
1VPY200	Gray	2	100
1VPY212	Gray	2-1/2	100
1VPY300	Gray	3	100



1: ANCHORS



E-Z ANCHORS™

PART NUMBER	MATERIAL	SCREW SIZE	QTY
1EZAZ	Zinc	8	100
1EZZM	Zinc Mini	6	100
1EZAN	Nylon	8	100
1EZNL	Nylon Lite	6	100



E-Z ANCHOR KITS

PART NUMBER	MATERIAL	SCREW SIZE	BIT SIZE	BOX QTY
1ZKIT	Zinc	8 x 1	#2 x 2	50
1NKIT	Nylon	8 x 1	#2 x 2	50



ZIPITS™

PART NUMBER	MATERIAL	SCREW SIZE	QTY
1ZZIP	Zinc	8	100
1ZZJR	Zinc Jr	6	100
1NZIP	Nylon	8	100
1NZJR	Nylon Jr	6	100



LAG SCREW SHIELDS, ZAMAC ALLOY

The lag screw shield is a screw type anchor designed for use with lag bolts. It is suitable for use in concrete and the mortar joints of block or brick walls.

PART NUMBER	SIZE	DRILL SIZE	LENGTH OF SHIELD	QTY
1LSS14	1/4	1/2	1	50
1LSL14	1/4	1/2	1-1/2	50
1LSS56	5/16	1/2	1-1/4	50
1LSL56	5/16	1/2	1-3/4	50
1LSS38	3/8	5/8	1-3/4	50
1LSL38	3/8	5/8	2-1/2	50
1LSS12	1/2	3/4	2	25
1LSL12	1/2	3/4	3	25
1LSS58	5/8	7/8	2	25
1LSL58	5/8	7/8	3-1/2	25
1LSS34	3/4	1	2	25
1LSL34	3/4	1	3-1/2	25



PLASTIC TOGGLES

Plastic toggles are ideal for light to medium duty fastening applications and work in any hollow, thick or solid wall. They are fast and easy to install, and use any screw size from #6-14. This anchor is extremely adaptable to different wall materials.

PART NUMBER	SIZE	GRIP RANGE	HOLE SIZE	QTY
1PSTS	Small	1/8 - 1/4	5/16	100
1PSTM	Medium	3/8 - 1/2	5/16	100
1PSTL	Large	5/8 - 3/4	5/16	100



HOLLOW WALL ANCHORS

The hollow wall anchor is designed to be used in plaster, wallboard, concrete block, hollow tile or plywood. They are quick and easy to install but won't crack walls or crumble plaster. This anchor allows for fixture removal as often as needed.

PART NUMBER	SIZE	GRIP RANGE	DRILL SIZE	BODY LENGTH	SCREW LENGTH	QTY
1HWA18X	1/8 XS	1/16 - 1/4	1/4	3/4	1	100
1HWA18S	1/8 S	1/8 - 1/2	1/4	1-1/4	1-1/2	100
1HWA18L	1/8 L	5/8 - 7/8	1/4	1-5/8	2	100
1HWA36S	3/16 S	1/8 - 5/8	3/8	2-1/16	2-1/4	50
1HWA36L	3/16 L	5/8 - 1-13/16	3/8	2-1/2	2-3/4	50
1HWA14S	1/4 S	1/8 - 5/8	1/2	2-1/16	2-1/4	50
1HWA14L	1/4 L	5/8 - 1-13/16	1/2	2-1/2	2-3/4	50



HOLLOW WALL ANCHORS - DRIVE TYPE

PART NUMBER	SIZE	GRIP RANGE	DRILL SIZE	BODY LENGTH	SCREW LENGTH	QTY
1HWA18SD	1/8 SD	1/8 - 1/2	1/4	1-1/4	1-21/32	100
1HWA18LD	1/8 LD	5/8 - 7/8	1/4	1-3/4	2-5/16	100



MACHINE SCREW ANCHORS, LEAD

This expansion anchor is ideal for anchoring in a shallow hole in concrete, brick, block or stone. The anchor is set by expanding a lead ring over a threaded cone, using a setting tool.

PART NUMBER	SIZE	DRILL SIZE	ANCHOR LENGTH	QTY
1MSA0632	6-32	5/16	17/32	100
1MSA0832	8-32	5/16	17/32	100
1MSA1024	10-24	3/8	11/16	100
1MSA1420	1/4-20	1/2	7/8	100
1MSA5618	5/16-18	5/8	1	100
1MSA3816	3/8-16	3/4	1-1/4	100
1MSA1213	1/2-13	7/8	1-1/2	100



CLOSED END MACHINE SCREW ANCHORS

The closed end machine screw anchor is a proprietary, internally threaded insert made of zinc alloy (zamac). Often used to assist in mounting sinks to the underside of stone countertops, this insert must be glued in place with a suitable epoxy-type adhesive. The anchor has 6 longitudinal ribs which enhance the adhesion process and help prevent it from spinning as a fastener is tightened.

PART NUMBER	SIZE	QTY
1MSA1024CE	10-24	1000



1: ANCHORS



.300 HEAD POWDER ACTUATED DRIVE PINS

Drive pins with a .300 diameter head are designed for permanently fastening a fixture to concrete, some types of masonry and A36 structural steel.

PART NUMBER	SHANK LENGTH	QTY
1PAP3012	1/2 knurled	100
1PAP3058	5/8 knurled	100
1PAP3034	3/4	100
1PAP3100	1	100
1PAP3114	1-1/4	100
1PAP3112	1-1/2	100
1PAP3134	1-3/4	100
1PAP3200	2	100
1PAP3214	2-1/4	100
1PAP3238	2-3/8	100
1PAP3212	2-1/2	100
1PAP3300	3	100



.300 HEAD DRIVE PINS. WITH 3/4" WASHER

PART NUMBER	SHANK LENGTH	QTY
1PAP310034W	1	100
1PAP311434W	1-1/4	100
1PAP311234W	1-1/2	100
1PAP320034W	2	100
1PAP303434W	3/4	100
1PAP321234W	2-1/2	100
1PAP330034W	3	100



.300 HEAD DRIVE PINS. WITH 7/8" WASHER

PART NUMBER	SHANK LENGTH	QTY
1PAP310078W	1	100
PAP311478W	1-1/4	100
1PAP311278W	1-1/2	100
1PAP320078W	2	100
1PAP321278W	2-1/2	100
1PAP330078W	3	100



.300 HEAD DRIVE PINS. WITH 1" WASHER

PART NUMBER	SHANK LENGTH	QTY
1PAP310001W	1	100
1PAP311401W	1-1/4	100
1PAP311201W	1-1/2	100
1PAP320001W	2	100
1PAP321201W	2-1/2	100
1PAP330001W	3	100



.27 CAL SAFETY STRIP LOADS

PART NUMBER	COLOR	QTY
1SSL27BN	Brown	100
1SSL27GN	Green	100
1SSL27YW	Yellow	100
1SSL27RD	Red	100

